

Certificate of Owner  
KNOWN BY ALL MEN THESE PRESENTS; that the undersigned does hereby certify that it is the owner of a certain tract of land to be known as ARBOR RIDGE SUBDIVISION NO. 2, and that it intends to include the following described land in this plat:  
A portion of the northeast quarter of Section 14, Township 2 North, Range 1 West, Boise Meridian, Kuna City, Ada County, Idaho, being more particularly described as follows:

# Arbor Ridge Subdivision No. 2

Commencing at the northeast corner of said Section 14; thence S00°19'50"E, 2,643.85 feet along the centerline of Linder Road and the easterly boundary of the northeast quarter of said Section 14 to the southeast corner of the northeast quarter of said Section 14; thence S89°56'20"W, 925.14 feet along the southerly boundary of the northeast quarter of said Section 14; thence continuing S89°56'20"W, 89.86 feet along the southerly boundary of the northeast quarter of said Section 14; thence N10°49'45"W, 49.80 feet to the Point of Beginning:

Thence S80°54'11"W, 75.91 feet;

Thence S89°56'20"W, 436.11 feet along a line parallel to the southerly boundary of the northeast quarter of said Section 14;

Thence N00°03'40"W, 108.00 feet;

Thence N25°42'08"W, 55.46 feet;

Thence N00°03'40"W, 389.63 feet;

Thence 220.07 feet along a tangent curve deflecting to the left, having a radius of 400.00 feet, a central angle of 31°31'22", a long chord bearing of N15°49'21"W, and a long chord distance of 217.31 feet;

Thence N43°49'25"E, 51.67 feet to the southeasterly boundary of Arbor Ridge Subdivision No. 1 as shown in Book 96 of Plats Pages 12069 through 12074 Records, Ada County, Idaho;

Thence the following courses and distances along the said southeasterly boundary of said Arbor Ridge Subdivision No. 1:

N58°24'58"E, 100.00 feet;

N47°26'17 E, 50.93 feet;

N58°24'58"E, 200.00 feet;

N70°15'13"E, 51.09 feet;

N58°24'58"E, 97.65 feet;

Thence the following courses and distances along the southwesterly boundary of said Arbor Ridge Subdivision No. 1:

S31°35'02"E, 79.03 feet;

S25°15'35"E, 76.00 feet;

S20°40'29"E, 76.00 feet;

S16°05'24"E, 80.02 feet;

S58°07'20"E, 56.72 feet;

Thence leaving said southwesterly boundary of said Arbor Ridge Subdivision No. 1, S00°00'00"E, 269.00 feet;

Thence S89°56'35"W, 132.32 feet;

Thence S12°29'47"E, 284.70 feet;

Thence S10°49'45"E, 183.65 feet to the Point of Beginning.

Comprising 11.26 acres more or less

The public streets shown on this plat are hereby dedicated to the public; the easements shown on this plat are not dedicated to the public, but the right to use said easements is hereby reserved for the uses specifically depicted on the plat, and for any other purposes designated hereon. The lots within this subdivision are eligible to receive water service from the City of Kuna; and the City of Kuna has agreed in writing to serve all of the lots within this subdivision.

IN WITNESS WHEREOF: I have hereunto set my hand on this 14<sup>th</sup> day of July, 2014.

  
\_\_\_\_\_  
Corey D. Barton, President  
Corey Barton Homes, Inc. Date

## Acknowledgment

State of Idaho)  
\_\_\_\_\_)ss.  
County of Ada)

On this 14<sup>th</sup> day of July, in the year of 2014, before me the undersigned, a Notary Public in and for said state, personally appeared Corey D. Barton, known or identified to me to be the President of Corey Barton Homes, Inc. the corporation that executed the instrument or the person who executed the instrument on behalf of said corporation and acknowledged to me that such corporation executed the same.

IN WITNESS WHEREOF: I have set my hand and seal the day and year in this certificate first above written.

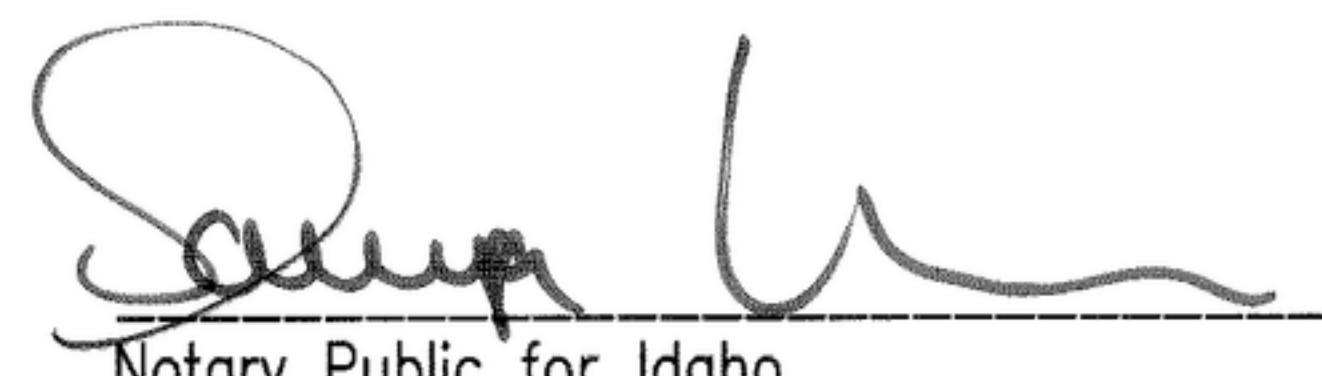
  
\_\_\_\_\_  
Notary Public for Idaho  
Residing in Boise, Idaho  
My Commission Expires 7/16/16

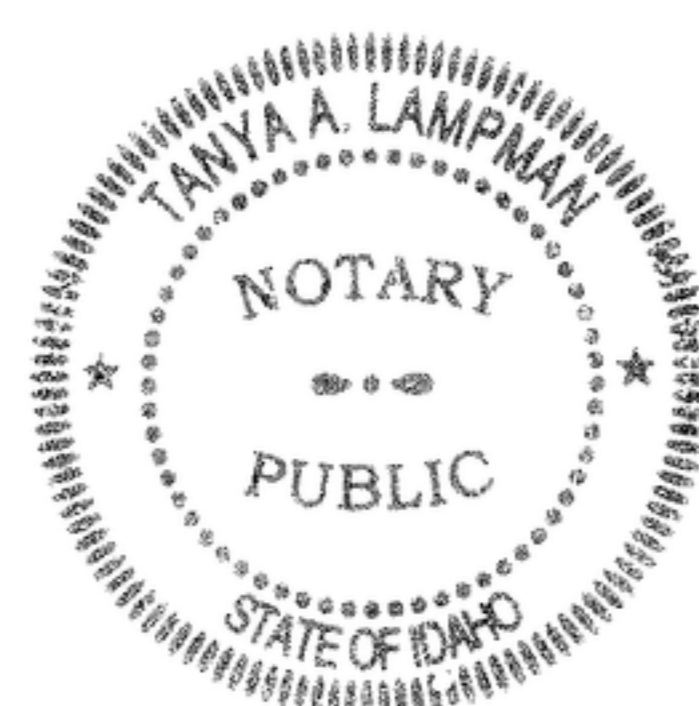

## Certificate of Surveyor

I, JOSEPH D. CANNING, do hereby certify that I am a Professional Land Surveyor, licensed by the State of Idaho, and that this plat of Arbor Ridge Subdivision No. 2 as described in the Certificate of Owners and as shown on the attached plat, was drawn from an actual survey made on the ground under my supervision, and accurately and correctly represents the points plotted thereon, and is in conformance with the State of Idaho Code relating to plats and surveys.

Joseph D. Canning, P.L.S. No. 4116



## Approval of Central District Health Department

Sanitary restrictions as required by Idaho Code, Title 50, Chapter 13 have been satisfied according to the letter to be read on file with the County Recorder or his agent listing the conditions of approval. Sanitary restrictions may be re-imposed, in accordance with Section 50-1326, Idaho Code, by the issuance of a certificate of disapproval.

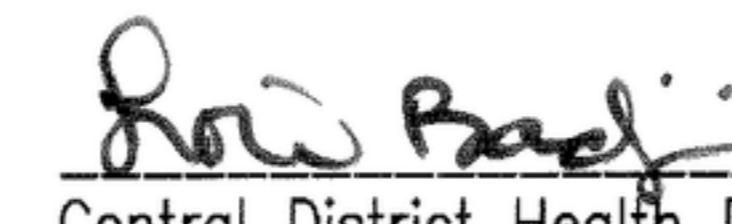
  
\_\_\_\_\_  
Central District Health Department, EHS Date

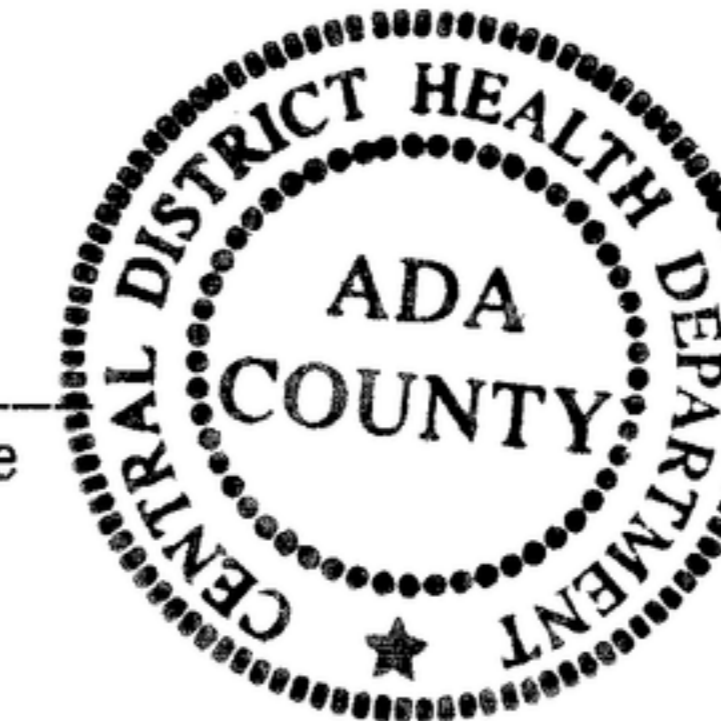

## Approval of Ada County Highway District

The foregoing plat was accepted and approved by the Board of Ada County Highway District Commissioners on the 15<sup>th</sup> day of OCTOBER, 2014.

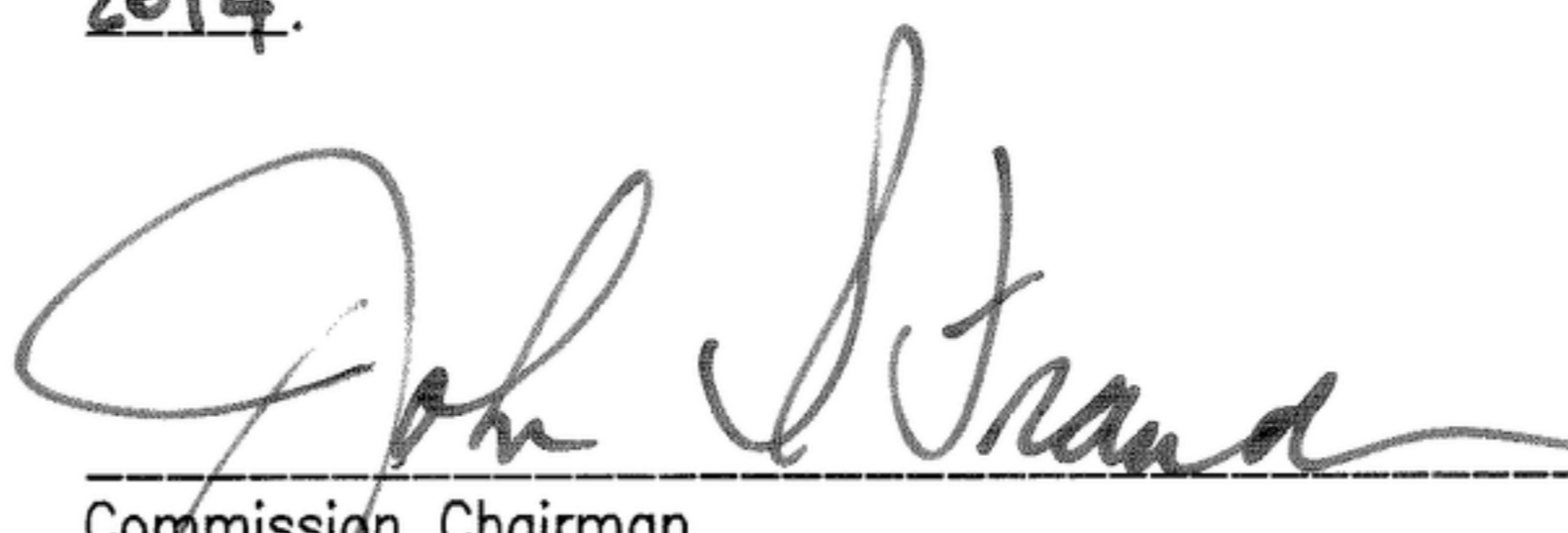
  
\_\_\_\_\_  
Commission Chairman  
Ada County Highway District



## Approval of City Engineer

I, the undersigned, the City Engineer in and for the City of Kuna, Ada County, Idaho, on this 25 day of Nov., 2014 hereby approve this plat.

  
\_\_\_\_\_  
Kuna City Engineer Date

## Approval of City Council

I, the undersigned, City Clerk in and for the City of Kuna, Ada County, Idaho, do hereby certify that at a regular meeting of the City Council held on the 5<sup>th</sup> day of Nov., 2014, this plat was duly accepted and approved.

  
\_\_\_\_\_  
Kuna City Clerk



## Certificate of County Surveyor

I, the undersigned, County Surveyor, in and for Ada County, Idaho, do hereby certify that I have checked this plat and that it complies with the State of Idaho Code relating to plats and surveys.

  
\_\_\_\_\_  
Ada County Surveyor Date 2-5-2015  
PLS 5359

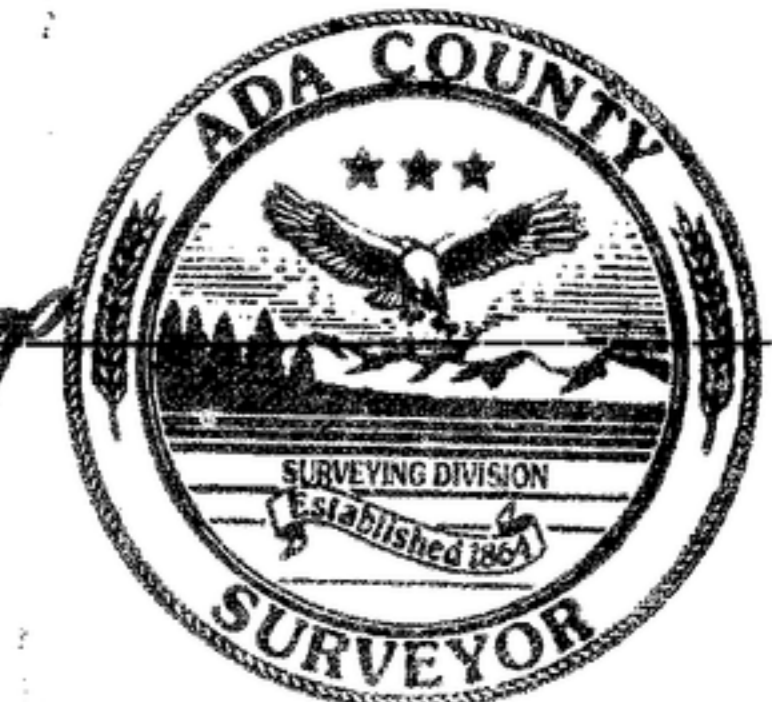

## Certificate of County Treasurer

I, the undersigned, County Treasurer in and for the County of Ada, State of Idaho, per requirements of Idaho Code 50-1308, do hereby certify that any and all current and/or delinquent county property taxes for the property included in this proposed subdivision have been paid in full. This certificate is valid for the next thirty (30) days only.

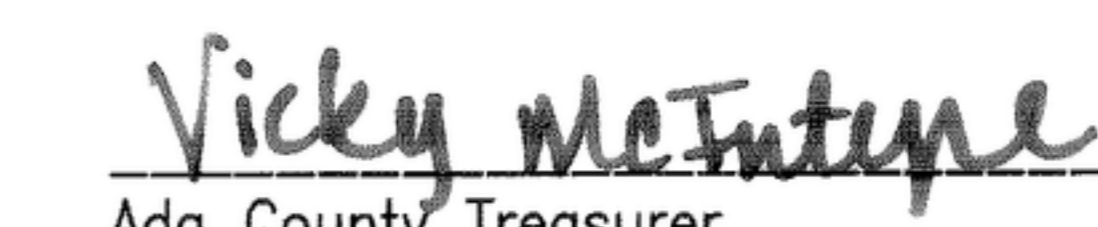
  
\_\_\_\_\_  
by deputy treasurer  
Katie Miller Date 2-2-15



## Certificate of County Recorder

State of Idaho)  
\_\_\_\_\_)ss. Instrument No. 2015-010038  
County of Ada)

I hereby certify that this instrument was filed at the request of B+A Engineers at 16 minutes past 10 o'clock A.M., this 9 day of February, 2015 in my office, and was recorded in Book 108 of Plats at Pages 15062 through 15064 Fee: 16.00

Ex-Officio Recorder: Christopher D. Rich

Deputy: 



## B&A Engineers, Inc.

Consulting Engineers, Surveyors & Planners  
5505 W. Franklin Rd. Boise, Id. 83705  
(208) 343-3381 Arbor Ridge Subdivision No. 2  
Sheet 3 of 3