

RESEARCH CENTER NO. 3

CERTIFICATE OF OWNERS

KNOW ALL MEN BY THESE PRESENTS: THAT BOISE RESEARCH CENTER, INC., AN IDAHO CORPORATION, IS THE OWNER OF THE PROPERTY DESCRIBED AS FOLLOWS:

A PARCEL OF LAND BEING ALL OF LOT 4 OF BLOCK 5 OF RESEARCH CENTER NO. 2, A SUBDIVISION, AS FILED FOR RECORD IN THE OFFICE OF THE ADA COUNTY RECORDER, BOISE, IDAHO IN BOOK 60 OF PLATS AT PAGES 6940 THROUGH 6942, LYING IN THE NE1/4 OF THE NE1/4 OF SECTION 28, T.4N., R.1E., B.M., BOISE, ADA COUNTY, IDAHO AND MORE PARTICULARLY DESCRIBED AS FOLLOWS; COMMENCING AT THE BRASS CAP MARKING THE ONE-QUARTER CORNER COMMON TO SECTION 21 AND THE SAID SECTION 28; THENCE NORTH 89°56'40" EAST 2641.30 FEET ALONG THE NORTHERLY BOUNDARY OF SAID NE1/4 OF SECTION 28, WHICH IS ALSO THE CENTERLINE OF CHINDEN BOULEVARD (STATE HIGHWAY 20-26) TO A BRASS CAP MARKING THE SECTION CORNER COMMON TO SECTIONS 22 AND 27 AND THE SAID SECTIONS 21 AND 28; THENCE SOUTH 89°56'40" WEST 575.04 FEET ALONG THE SAID NORTHERLY BOUNDARY OF THE NE1/4 OF SECTION 28 TO A POINT; THENCE SOUTH 0°13'10" WEST 75.28 FEET TO A 2-INCH GALVANIZED PIPE MARKING THE NORTHEAST CORNER OF THE SAID LOT 4 OF BLOCK 5 OF RESEARCH CENTER NO. 2, ALSO SAID POINT BEING THE REAL POINT OF BEGINNING (INITIAL POINT); THENCE ALONG THE EASTERLY, SOUTHERLY, WESTERLY AND NORTHERLY BOUNDARIES, RESPECTIVELY, OF THE SAID LOT 4 OF BLOCK 5 OF RESEARCH CENTER NO. 2 THE FOLLOWING COURSES AND DISTANCES TO IRON PINS: SOUTH 0°13'10" WEST 295.04 FEET TO A POINT OF BEGINNING OF CURVE; THENCE SOUTHWESTERLY ALONG A CURVE TO THE LEFT 86.01 FEET, SAID CURVE HAVING A CENTRAL ANGLE OF 82°07'54", A RADIUS OF 60.00 FEET, TANGENTS OF 52.28 FEET AND A LONG CHORD OF 78.83 FEET BEARING SOUTH 49°09'13" WEST TO A POINT OF ENDING OF CURVE; THENCE SOUTH 89°56'36" WEST 445.00 FEET; THENCE NORTH 81°01'55" WEST 159.38 FEET TO A POINT OF BEGINNING OF CURVE; THENCE NORTHWESTERLY ALONG A CURVE TO THE RIGHT 46.50 FEET, SAID CURVE HAVING A CENTRAL ANGLE OF 2°59'18", A RADIUS OF 891.56 FEET, TANGENTS OF 23.26 FEET AND A LONG CHORD 46.49 FEET BEARING NORTH 1°33'07" WEST TO A POINT OF TANGENT; THENCE NORTH 0°03'20" WEST 250.35 FEET TO A POINT OF CURVE; THENCE NORTHEASTERLY ALONG A CURVE TO THE RIGHT 47.12 FEET, SAID CURVE HAVING A CENTRAL ANGLE OF 90°00'00", A RADIUS OF 30.00 FEET, TANGENTS OF 30.00 FEET AND A LONG CHORD OF 42.43 FEET BEARING NORTH 44°56'40" EAST TO A POINT OF TANGENT; THENCE NORTH 89°56'40" EAST 287.94 FEET TO A POINT OF CURVE; THENCE SOUTHEASTERLY ALONG A CURVE TO THE RIGHT 346.83 FEET, SAID CURVE HAVING A CENTRAL ANGLE OF 1°44'41", A RADIUS OF 11,389.16 FEET, TANGENTS OF 173.43 FEET AND A LONG CHORD OF 346.82 FEET BEARING SOUTH 89°10'59" EAST TO THE POINT OF BEGINNING, COMPRISING 5.24 ACRES, MORE OR LESS.

IT IS THE INTENTION OF THE UNDERSIGNED TO HEREBY INCLUDE THE ABOVE DESCRIBED PROPERTY IN THIS PLAT. THE EASEMENTS AS SHOWN ON THIS PLAT ARE NOT DEDICATED TO THE PUBLIC. HOWEVER, THE RIGHT TO USE SAID EASEMENTS IS HEREBY PERPETUALLY RESERVED FOR PUBLIC UTILITIES AND SUCH OTHER USES AS DESIGNATED WITHIN THIS PLAT AND NO PERMANENT STRUCTURES ARE TO BE ERRECTED WITHIN THE LINE OF SAID EASEMENTS. ALL LOTS IN THIS SUBDIVISION WILL BE ELIGIBLE TO RECEIVE WATER SERVICE FROM AN EXISTING UNITED WATER IDAHO, INC. MAIN LINE LOCATED ADJACENT TO THE SUBJECT SUBDIVISION, AND UNITED WATER IDAHO, INC. HAS AGREED IN WRITING TO SERVE ALL THE LOTS IN THIS SUBDIVISION.

IN WITNESS WHEREOF, WE HAVE SET OUR HANDS THIS 1ST DAY OF NOVEMBER, 1994. BOISE RESEARCH CENTER, INC.

David W. Turnbull
DAVID W. TURNBULL
VICE-PRESIDENT

ACKNOWLEDGEMENT

STATE OF IDAHO }
COUNTY OF ADA } S.S.

ON THIS 1ST DAY OF November, 1994, BEFORE ME, THE UNDERSIGNED, A NOTARY PUBLIC IN AND FOR SAID STATE, PERSONALLY APPEARED DAVID W. TURNBULL, KNOWN OR IDENTIFIED TO ME TO BE THE VICE-PRESIDENT OF BOISE RESEARCH CENTER, INC., AN IDAHO CORPORATION, WHOSE NAME IS SUBSCRIBED TO THE WITHIN INSTRUMENT AND ACKNOWLEDGED TO ME THAT SAID CORPORATION EXECUTED THE SAME.

IN WITNESS WHEREOF, I HAVE HEREUNTO SET MY HAND AND AFFIXED MY OFFICIAL SEAL THE DAY AND YEAR IN THIS CERTIFICATE FIRST ABOVE WRITTEN.

May 13, 1999
MY BOND EXPIRES

Marina Beynon
NOTARY PUBLIC FOR IDAHO
RESIDING IN BOISE, IDAHO

RECORDER'S CERTIFICATE

STATE OF IDAHO }
COUNTY OF ADA } S.S.

I HEREBY CERTIFY THAT THIS INSTRUMENT WAS FILED FOR RECORD AT THE REQUEST OF Mike Tanner AT 25 MINUTES PAST 11 O'CLOCK A.M., ON THIS 24 DAY OF August, IN 1995 BOOK 70 OF PLATS AT PAGES 7160 AND 7161. INSTRUMENT NO. 95060368

D. Hall
DEPUTY 11-00

David Navarro
EX-OFFICIO RECORDER

CERTIFICATE OF SURVEYOR

I, D. TERRY PEUGH, DO HEREBY CERTIFY THAT I AM A PROFESSIONAL LAND SURVEYOR LICENSED BY THE STATE OF IDAHO, AND THAT THIS PLAT AS DESCRIBED IN THE "CERTIFICATE OF OWNERS" WAS DRAWN FROM AN ACTUAL SURVEY MADE ON THE GROUND UNDER MY DIRECT SUPERVISION AND ACCURATELY REPRESENTS THE POINTS PLATTED THEREON, AND IS IN CONFORMITY WITH THE STATE OF IDAHO CODE RELATING TO PLATS AND SURVEYS.

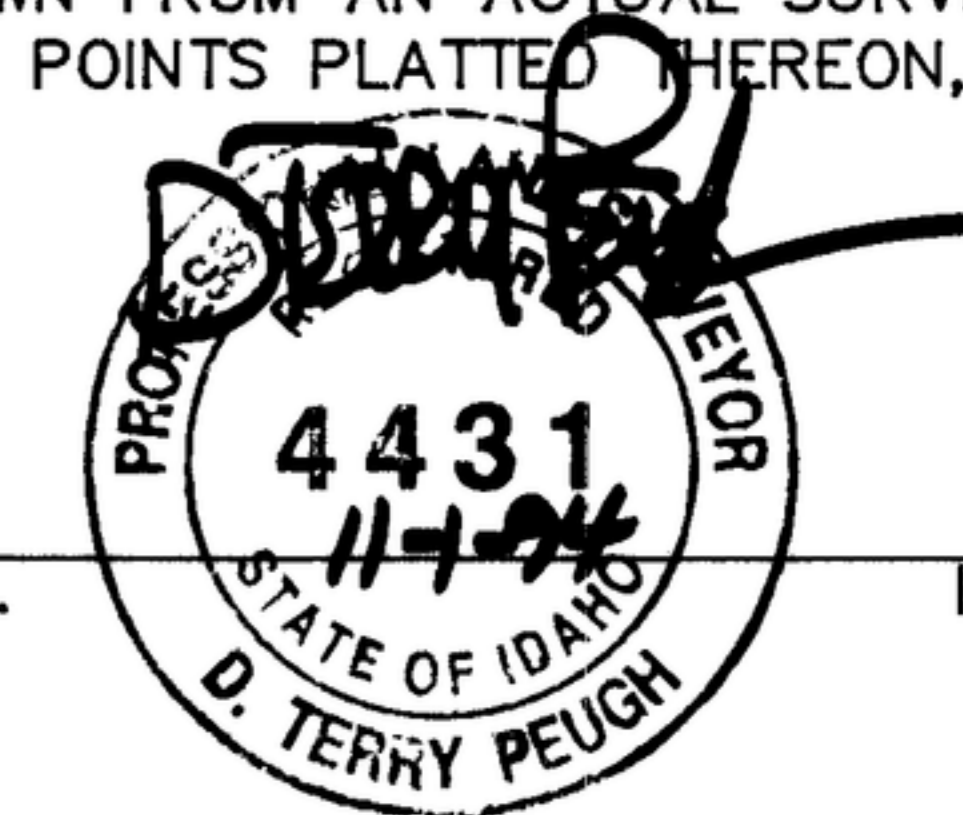

D. TERRY PEUGH, L.S. IDAHO NO. 4431

APPROVAL OF ADA COUNTY HIGHWAY DISTRICT

THE FOREGOING PLAT WAS ACCEPTED AND APPROVED BY THE BOARD OF ADA COUNTY HIGHWAY DISTRICT COMMISSIONERS ON THE 16th DAY OF November 1994.

Sherry R. Tucker
CHAIRMAN

APPROVAL OF CENTRAL DISTRICT HEALTH DEPARTMENT

SANITARY RESTRICTIONS OF THIS PLAT ARE HEREBY REMOVED ACCORDING TO THE LETTER TO BE READ ON FILE WITH THE COUNTY RECORDER OR HIS AGENT LISTING THE CONDITIONS OF APPROVAL.

Thomas E. Schmas 12/6/94
CENTRAL DISTRICT HEALTH DEPARTMENT

APPROVAL OF CITY ENGINEER

I, THE UNDERSIGNED, CITY ENGINEER IN AND FOR THE CITY OF BOISE, ADA COUNTY, IDAHO, HEREBY APPROVE THIS PLAT.

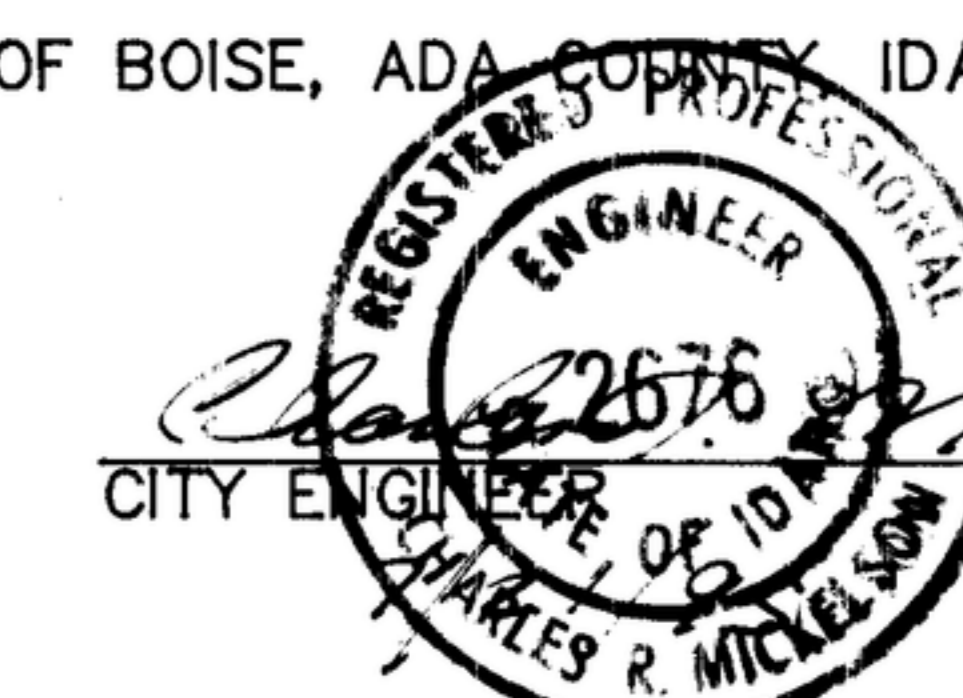

APPROVAL OF CITY COUNCIL

I, THE UNDERSIGNED, CITY CLERK IN AND FOR THE CITY OF BOISE, ADA COUNTY, IDAHO, DO HEREBY CERTIFY THAT AT A REGULAR MEETING OF THE CITY COUNCIL HELD ON THE 25th DAY OF August, 1994, THIS PLAT WAS DULY ACCEPTED AND APPROVED.

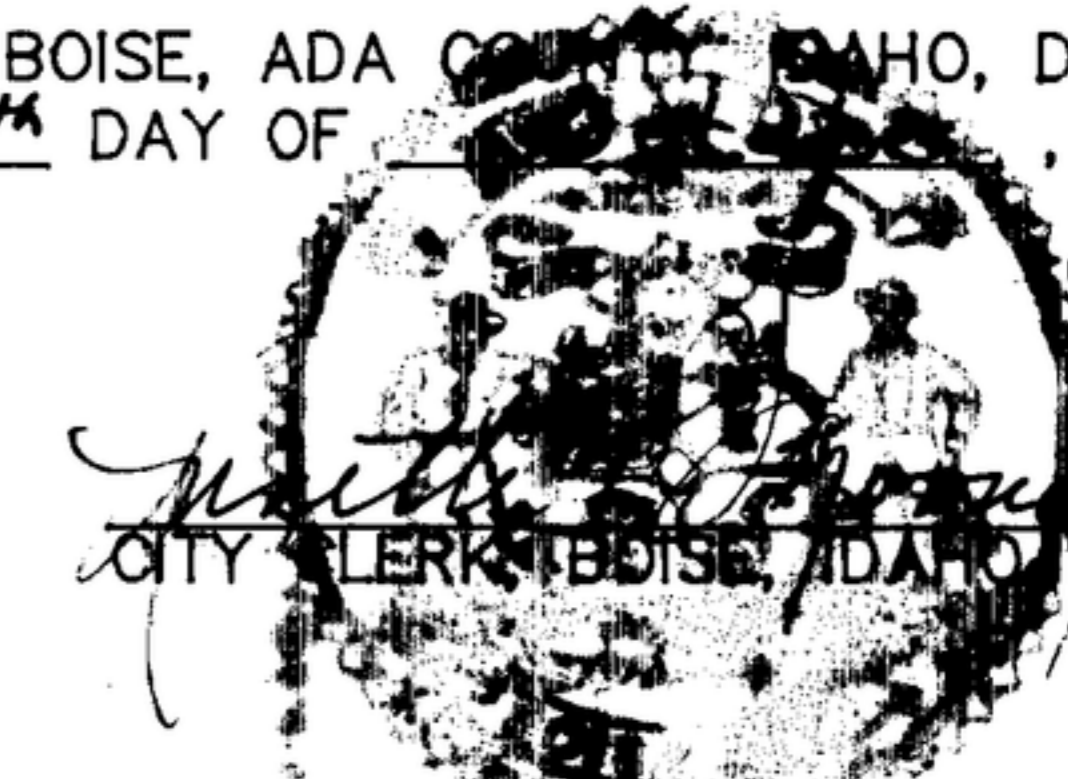

John E. Priestner
CITY CLERK BOISE, IDAHO 7-21-95

CERTIFICATE OF COUNTY SURVEYOR

I, THE UNDERSIGNED, COUNTY SURVEYOR, IN AND FOR ADA COUNTY, IDAHO, DO HEREBY CERTIFY THAT I HAVE CHECKED THIS PLAT AND THAT IT COMPLIES WITH THE STATE OF IDAHO CODE RELATING TO PLATS AND SURVEYS.

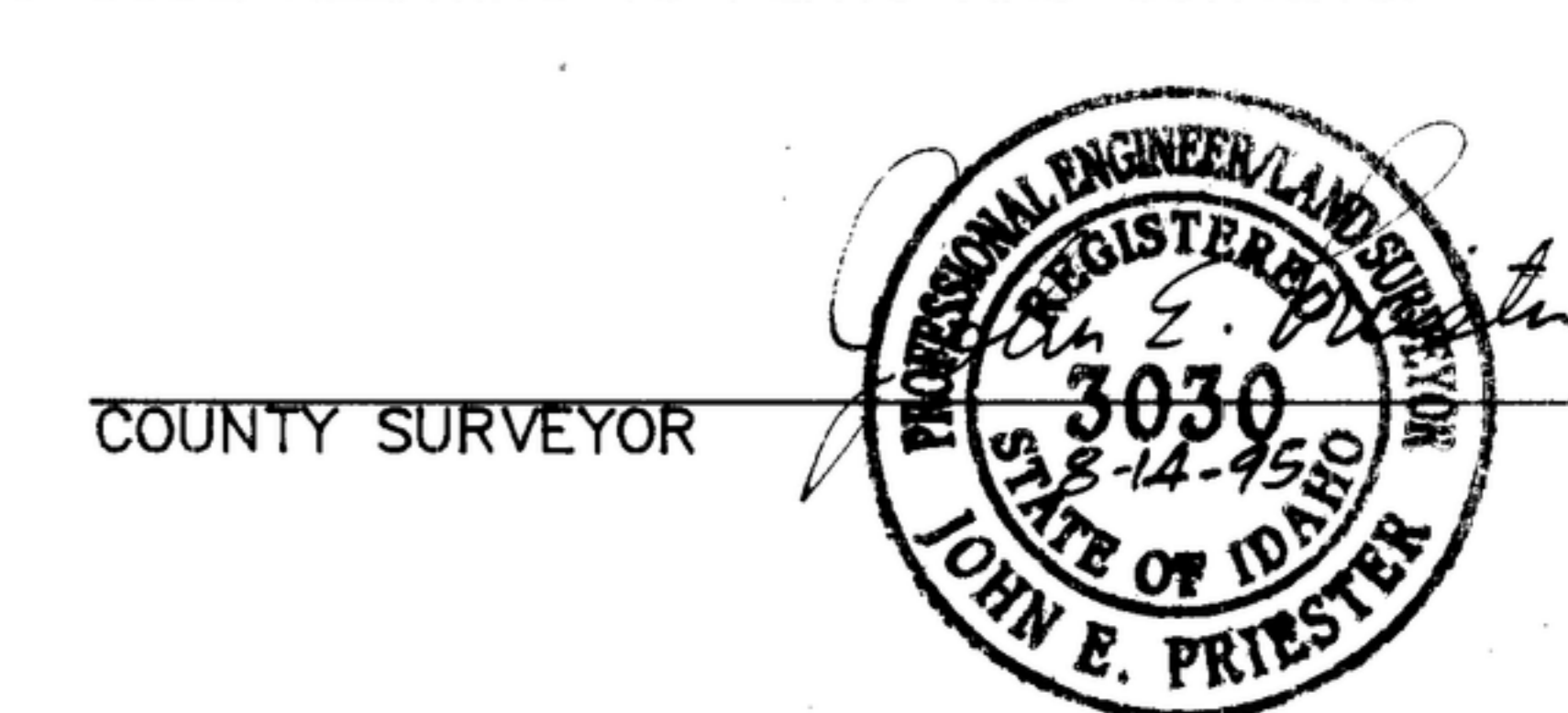

COUNTY SURVEYOR

CERTIFICATE OF THE COUNTY TREASURER

I, THE UNDERSIGNED, COUNTY TREASURER IN AND FOR THE COUNTY OF ADA, STATE OF IDAHO, PER THE REQUIREMENTS OF I.C. 50-1308 DO HEREBY CERTIFY THAT ANY AND ALL CURRENT AND/OR DELINQUENT COUNTY PROPERTY TAXES FOR THE PROPERTY INCLUDED IN THIS SUBDIVISION HAVE BEEN PAID IN FULL. THIS CERTIFICATION IS VALID FOR THE NEXT THIRTY (30) DAYS ONLY.

August 23, 1995
DATE

Barbara Bauer
COUNTY TREASURER
By Karen Witt, Dana Clarke